



CHABOT- LAS POSITAS COMMUNITY COLLEGE DISTRICT

Purchasing and Warehouse Services Department

December 6, 2007

Addendum No. 1 INVITATION FOR BID No. 08-10 Demolition of Buildings 400/600/700, Chabot College

All Prospective Bidders:

This Addendum modifies the original Bid Documents for the above Bid. Acknowledge receipt of this addendum in the space provided on the **SIGNATURE FORM**. Failure to do so may subject Bidder to disqualification. The original Bid Documents are modified by the additional information as follows:

Item No.	Location in Contract Documents, Specifications and Drawings	Description
1	RFI # 1 Section 01061-1-04	<p>Question: Is there a reclaimed water outlet on campus for the use of demolition dust control? If not, where will I get the reclaimed water from?</p> <p>Is there underground storage tank to be removed in this Project? Where will I apply for General construction activity storm water permit?</p> <p>Answer: Reclaimed water is not available onsite. Potable water may be used.</p> <p>There are no known underground storage tanks. Exclude from bid.</p> <p>The storm water permit is to be made through the State Water Resources Control Board. The application must be submitted at the onset of the project. District will assist in filling out application. www.waterboards.ca.gov (District)</p>
2	RFI # 2	<p>Question: Is Black Mastic present on interior of exterior walls of all buildings? It was discussed at job walk. I am not finding it noted on the survey.</p> <p>Answer: See answer to item 10</p>

3	RFI # 3 Sheet C321	<p>Question: Sheet C321 provides requirements for erosion control measures for buildings 600 & 700. Will building 400 have erosion controls measures in place by others since there is not sheet or reference available? If so, what will be installed by others prior to the demolition?</p> <p>Answer: Erosion Control is required for Bldg. 400. Contractor shall design/build erosion control solution similar to that developed for 600/700. SWPP Plan shall be submitted to District for approval prior to proceeding with work. (District)</p>
4	RFI # 4 Section 01060 of Spec Title 1.04 Permits	<p>Question: State Water Resources Control Board., General construction Activity Storm water; Where do I apply for this permit? Do I need to include underground storage tank removal?</p> <p>Answer: See Answer #1 (District)</p>
5	RFI # 5	<p>Question: We request that the Contractor License classification C-21, Demolition & Wrecking be added to paragraph 5 of the Notice to Contractors Call for Bids.</p> <p>Answer: This is acceptable. (District)</p>
6	RFI # 6 Exhibit A Specs	<p>Question: The existing walls of the building appear to be wood framed as well as precast panels. Will the abatement contractor be allowed to demolish the existing wood framed wall to remove the asbestos containing sealant adhered to the concrete columns?</p> <p>Answer: Yes (HMS)</p>
7	RFI # 7 Sheet #RHAA	<p>Question: Sheet title RHAA references relocation of existing trees. Is this work covered under our scope of work?</p> <p>Answer: No trees are to be relocated under this contract. Protection of existing trees not relocated is included in this scope of work. (District)</p>
8	RFI # 8	<p>Question: For the demolition of 400/600/700, should the work include a telecom contractor and electrical also, who will disconnect and pull back the voice and data backbone cabling?</p> <p>Answer: The scope of work includes removal of data cabling from the work site to building 300.</p> <p>Voice cabling shall be pulled back to the closest splice case/vault which is adjacent to building 1000. It shall be removed from the splice and then the splice resealed. The copper needs to be disconnected cleanly so there is no damage to the telephone system.</p> <p>Electrical cabling shall be removed from the building site to the switch approximately 60 feet west of building 600.</p> <p>Shutdowns of campus systems are necessary to achieve the above. This work shall be coordinated and scheduled with the District.</p>

		<p>Removal of conduit beyond 5' is not required.</p> <p>Work shall be performed by Licensed Telecom & Electrical Contractors (tBP)</p>
9	RFI # 9	<p>Question: There are two very time consuming items that are in the scope of work: a) sealants between concrete panels around doors and windows b) black moisture barrier on perimeter concrete walls.</p> <p>Because of the coordination between abatement and demolition, contractors perform item A and because item B will need to be a stand alone abatement scope, the schedule does not seem realistic. If the schedule is not revised it probably will be necessary to work multiple shifts and maybe weekends. Is this acceptable?</p> <p>Answer: Item b) does not exist - this is explained elsewhere in the addendum Item a) exists but will not present as labor intense a project as previously thought - see remainder of addendum</p> <p>Yes - if necessary, any work hours may be worked provided noise and light ordinances are not violated. (HMS)</p>
10	RFI # 10	<p>Question: The amount of sealant between concrete panels cannot be quantified without prior destructive demolition. Can this item be bid to specific quantity or are the bidders expected to make a random guess as to how much sealant will be uncovered?</p> <p>Answer: This sealant exists at doors, windows, between concrete panels, along columns, and between walls and under side of roof. This sealant is only two inches thick, unlike the ten inches described at the bid walk. The following approximate linear amounts of sealant exist on each building, but contractors are required to conduct their own measurements: Building 400 has approximately 310 linear feet of mastic Building 600 has approximately 910 linear feet of mastic Building 700 has approximately 2400 linear feet of mastic (HMS)</p>
11	RFI # 11	<p>Questions: Is black mastic present on interior of exterior walls of all buildings? It was discussed at job walk. I am not finding it noted on the survey.</p> <p>Answer: It does not exist of these buildings. The walls were opened up and this moisture barrier was not found to exist within these buildings. There is however a moisture barrier paper material</p>

		below the exterior stucco/aggregate sections of the buildings that is to be bid for removal as asbestos-containing material. (HMS)
12	RFI # 12	<p>Question: Page 3, last paragraph states that the contractor shall remove materials to the base substrate during abatement. These materials shall include asbestos and non asbestos containing materials. Is it the intent of the district to remove all non asbestos containing materials prior to the demolition? If so, does this include all mechanical, electrical and plumbing lines? Will all the non asbestos containing materials be left onsite and disposed of as construction debris?</p> <p>Answer: The scope of work includes the complete demolition of the subject buildings. (tBP)</p> <p>During the abatement phase, Non-asbestos materials must be removed prior to demolition only if required to access asbestos materials. Asbestos containing materials for this project include any material that contains any detectable amount of asbestos - this includes the roof and all interior drywall. Non-asbestos-containing materials (materials that do not contain any detectable level of asbestos) are not required to be removed by the abatement contractor unless they cover or impede access to asbestos-containing materials. (HMS)</p>
13	Bid Walk Question #1	<p>Question: Can existing walls be cored to determine thickness and presence of mastic.</p> <p>Answer: No, see item 20 (District)</p>
14	Bid Walk Question #2	<p>Questions: Are all Functional Space Notes for Building 400 assumed as indicated in the specification.</p> <p>Answer: No; Revised functional space noted for building 400 are attached. (See attachment C) (HMS)</p>
15	Clarification # 1	Contractors should be aware that transite pipes will be encountered below the slabs of each building. Contractor shall assume a length of 200 LF and a size of 12” dia. Contractor shall also include a unit price. Contract will be adjusted to reflect actual length encountered. (HMS)

16	Clarification # 2	All RACM must be disposed of as hazardous waste. (HMS)
17	Clarification #3	It is the responsibility of the contractor to assure BAAQMD notification for demolition is made in sufficient time to start the project on schedule. Failure to notify promptly and properly will not extend the contract time. (HMS)
18	Clarification #4	Attachment A indicates the approximate location of utilities within the project area. Contractor shall locate and protect existing utilities.
19	Clarification #5	Attachment B indicates location of new utility loop currently under construction. Bidders shall assume this trench will be completed and backfilled at the start of demolition. Contractor is responsible for protection of this loop. (District)
20	Clarification #7	<p><u>Exterior walls configuration and moisture barrier removal: (HMS)</u> At the bid-walk it was discussed that, due to finding in building 800 and 900 an interior moisture barrier was expected to be found on the interior of the exterior walls of the 400, 600, and 700 buildings. Exploration of these exterior walls, since the bidwalk, has shown that they are not identical to building 800 and 900.</p> <p>Previously the exterior wall panels were thought to be 8 to 10 inch thick concrete walls, this is not the case. While the columns remain solid concrete, the exterior wall panels of 400, 600, and 700 are comprised of stucco/aggregate, wire mesh, paper moisture barrier, plywood panel, 2 by 6 stud and interior wall surface. Please see page D5 of the blue prints for this project - horizontal section through wall at concrete column for detail of wall make up.</p> <p>The moisture barrier between the plywood and the wire mesh and the interior wall surfaces are to be handled as asbestos containing materials except where interior wall surfaces are shown to be asbestos free on the survey. The moisture barrier is not listed on the survey but covers the entire exterior walls of the building and must be bid to be removed as an asbestos containing material.</p>

		<p>The requirement to drop wall panels, separate them at joints and remove asbestos-containing mastic is hereby removed from the specifications, though this requirement still exists for roof sections and roof support columns and beams. Contractor may demolish wall panels and remove mastic from panels and columns in the most efficient manner possible provided the mastic is removed wet and is not made friable during the process.</p> <p>In no case will concrete materials be allowed to be disposed of or recycled with asbestos-containing mastic intact. Wooden wall panels and wire mesh may be disposed of with mastic and moisture barrier intact if packaging and disposal of these materials as asbestos-containing waste is more cost effective than cleaning the mastic and moisture barrier from them.</p>
--	--	---

All other terms and conditions of BID No. 08-10 to remain the same.

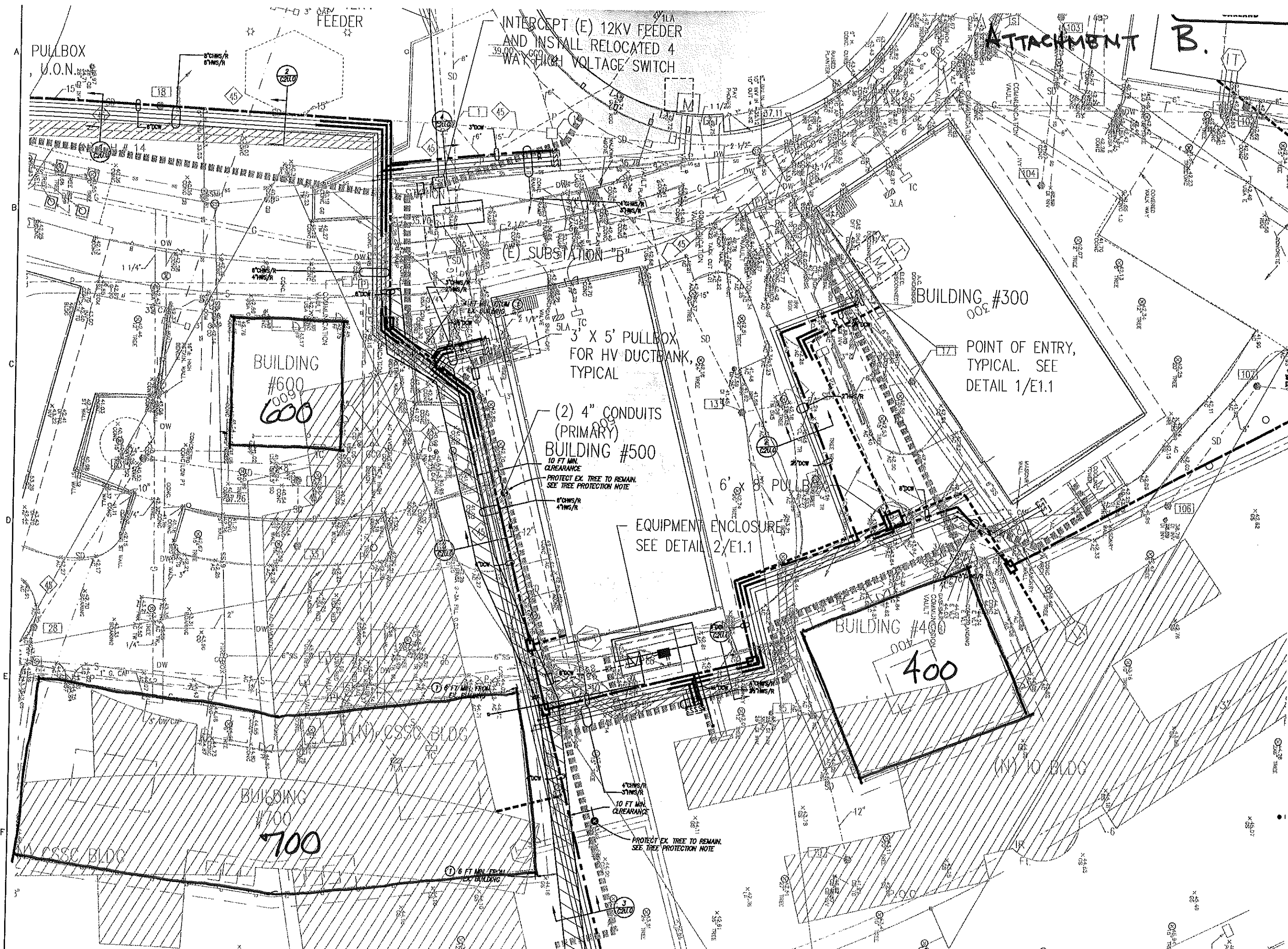

PULLBOX
U.O.N.

INTERCEPT (E) 12KV FEEDER
AND INSTALL RELOCATED 4
WAY 10KV VOLTAGE SWITCH

(E) SUBSTATION B

BUILDING #300

POINT OF ENTRY,
TYPICAL. SEE
DETAIL 1/E.1

BUILDING
#600

3' X 5' PULLBOX
FOR HV DUCTBANK,
TYPICAL

(2) 4" CONDUITS
(PRIMARY)
BUILDING #500

10 FT MIN.
CLEARANCE
PROTECT EX. TREE TO REMAIN.
SEE TREE PROTECTION NOTE

6' X 8' PULLBOX

EQUIPMENT ENCLOSURE
SEE DETAIL 2/E.1

BUILDING #400

(N) CSSC BLDG

BUILDING
#700

PROTECT EX. TREE TO REMAIN.
SEE TREE PROTECTION NOTE

(N) IO BLDG

6 FT MIN. FROM
EXIST. BUILDING

Functional Space Notes HAZARD MANAGEMENT SERVICES, INC.

Client: Chabot College

Site: Building 400

HMS Project Number: BA06302

Date of Inspection: September 13, 2006

Building:	Building 400					
Building Comment:	Need to look at attic components					
Materials	Material Class	Percent Asbestos	Hmgs Matrl #	Sampled Here?	Footage Sq/Ln/Jnts	Friable? Yes/No
Building: <u>Building 400</u>		Room: <u>Corridor 401 A</u>				
Floor:	VFT & Mastic (12" Blue Oatmeal)	MISC	None Detected	1	360 sq	
Baseboard:	Baseboard & Mastic (6" Green)	MISC	None Detected	2	132 in	
Walls:	Glass	NON	Non-Suspect			
	<i>Comment: E Wall of Corridor 401 A is glass Material Comment: Window seals are non-suspect Silicone</i>					
Walls:	Gypsum Board - Wallpaper	MISC	2 - 4 % Ch	3	960 sq	No
Ceiling:	ACT & Mastic on GypBrd (12" Fissured)	MISC	2 % Ch	4	360 sq	No
Building: <u>Building 400</u>		Room: <u>Corridor 401 B</u>				
Floor:	VFT & Mastic (12" Blue Oatmeal)	MISC	None Detected	1	480 sq	
Baseboard:	Baseboard & Mastic (6" Green)	MISC	None Detected	2	172 in	
Walls:	Gypsum Board - Rough Texture	SURF	None Detected	19 19A	31 sq	
	<i>Comment: Across from RM 415</i>					
Walls:	Gypsum Board - Wallpaper	MISC	2 - 4 % Ch	3 3B	1517 sq	No
Ceiling:	ACT & Mastic on GypBrd (12" Fissured)	MISC	2 % Ch	4	1548 sq	No
Building: <u>Building 400</u>		Room: <u>Corridor 401 C</u>				
Floor:	VFT & Mastic (12" Blue Oatmeal)	MISC	None Detected	1	480 sq	
Baseboard:	Baseboard & Mastic (6" Green)	MISC	None Detected	2	172 in	
Ceiling:	ACT & Mastic on GypBrd (12" Fissured)	MISC	2 % Ch	4	1548 sq	No
Building: <u>Building 400</u>		Room: <u>Corridor 401 D</u>				
Floor:	VFT & Mastic (12" Blue Oatmeal)	MISC	None Detected	1	192 sq	
Baseboard:	Baseboard & Mastic (6" Green)	MISC	None Detected	2	76 in	
Ceiling:	ACT & Mastic on GypBrd (12" Fissured)	MISC	2 % Ch	4	192 sq	No

Functional Space Notes

HAZARD MANAGEMENT SERVICES, INC.

Client: Chabot College

Site: Building 400

HMS Project Number: BA06302

Date of Inspection: September 13, 2006

Building: Building 400
Building Comment: *Need to look at attic components*

Materials	Material Class	Percent Asbestos	Hmgne Matri #	Samplod Here?	Footage Sq/Ln/Jnts	Friable? Yes/No
-----------	----------------	------------------	---------------	---------------	--------------------	-----------------

Building: <u>Building 400</u>		Room: <u>Exterior</u>				
Walls:	Exterior Stucco	SURF	None Detected	23	23A	420 sq
Walls:	Glass	NON	Non-Suspect			
<i>Comment: W Wall of Courtyard is glass Material Comment: Window seals are non-suspect Silicone</i>						
Walls:	Sealant (Exterior)	MISC	Assumed	15		53 sq No
<i>Comment: At ground level Material Comment: At the base of the walls in the Courtyard. This material is found on the exterior of the building between concrete slabs, and around window frames.</i>						
Walls:	Wood	NON	Non-Suspect			
<i>Comment: Unknown substrate.</i>						
Ground:	Concrete	NON	Non-Suspect			
Overhangs:	Exterior Stucco	SURF	None Detected	23		1800 sq
Roofs:	Roofing Material	MISC	Assumed	25		11960 sq No
<i>Comment: Roofing material is known ACM. Refer to HMS roofing report for roofing materials.</i>						

Building: <u>Building 400</u>		Room: <u>Lobby 400</u>				
Floor:	VFT & Mastic (12" Blue Oatmeal)	MISC	None Detected	1	1A	216 sq
Baseboard:	Baseboard & Mastic (8" Green)	MISC	None Detected	2	2A	48 ln
Walls:	Gypsum Board - Wallpaper	MISC	<u>2 - 4 % Ch</u>	3		540 sq No
<i>Comment: Glass windows in lobby are wood trim, no putty</i>						
Ceiling:	ACT & Mastic on GypBrd (12" Fissured)	MISC	<u>2 % Ch</u>	4		No

Building: <u>Building 400</u>		Room: <u>RM 403/402 Conference Room</u>				
Floor:	VFT & Mastic (8" Olive)	MISC	<u>3 % Ch</u>	5		360 sq No
Baseboard:	Baseboard & Mastic (4" Olive)	MISC	<u><1 % An</u>	8		76 ln No
Walls:	Gypsum Board - Wallpaper	MISC	<u>2 - 4 % Ch</u>	3		684 sq No
Walls:	Wood	NON	Non-Suspect			
<i>Comment: Wood on Gyp Board, Chalkboard and Whiteboard attached w/screws</i>						
Ceiling:	ACT & Mastic on GypBrd (12" Fissured)	MISC	<u>2 % Ch</u>	4		360 sq No
Accordion Door:	Vinyl	NON	Non-Suspect			

Functional Space Notes

HAZARD MANAGEMENT SERVICES, INC.

Client: Chabot College

Site: Building 400

HMS Project Number: BA06302

Date of Inspection: September 13, 2006

Building: Building 400
Building Comment: *Need to look at attic components*

Materials	Material Class	Percent Asbestos	Hmgns Matri #	Sampled Here?	Footage Sq/Ln/Jnts	Friable? Yes/No
-----------	----------------	------------------	---------------	---------------	--------------------	-----------------

Building: <u>Building 400</u>		Room: <u>RM 404 Men's Restroom</u>				
Floor:	Ceramic Tile & Grout (1" White/Rose)	MISC	None Detected	20		120 sq
	<i>Comment: Tiles non-suspect for asbestos but grout and mortar base may contain asbestos - sampled. See lead report for potential lead-glass coating.</i>					
Walls:	Ceramic Tile & Grout (2")	MISC	None Detected	21		396 sq
	<i>Comment: Tiles are Beige in color Material Comment: Tiles non-suspect for asbestos but grout and mortar base may contain asbestos - sampled. See lead report for potential lead-glass coating.</i>					
Ceiling:	False Ceiling Panel (2x4 Pinhole)	MISC	None Detected	22		120 sq

Building: <u>Building 400</u>		Room: <u>RM 405 Women's Restroom</u>				
Floor:	Ceramic Tile & Grout (1" White/Rose)	MISC	None Detected	20	20A	80 sq
	<i>Comment: Tiles non-suspect for asbestos but grout and mortar base may contain asbestos - sampled. See lead report for potential lead-glass coating.</i>					
Walls:	Ceramic Tile & Grout (2")	MISC	None Detected	21	21A	324 sq
	<i>Comment: Tiles are Pink in Color Material Comment: Tiles non-suspect for asbestos but grout and mortar base may contain asbestos - sampled. See lead report for potential lead-glass coating.</i>					
Ceiling:	False Ceiling Panel (2x4 Pinhole)	MISC	None Detected	22	22A	80 sq

Building: <u>Building 400</u>		Room: <u>RM 406 Storage</u>				
Floor:	VFT & Mastic (9" Olive)	MISC	3 % Ch	5		72 sq No
Baseboard:	Baseboard & Mastic (4" Olive)	MISC	<1 % An	8		36 ln No
Walls:	Gypsum Board - Smooth Texture	MISC	<1 % Ch	9	9A	324 sq No
Ceiling:	Gypsum Board - Smooth Texture	MISC	<1 % Ch	9		72 sq No

Building: <u>Building 400</u>		Room: <u>RM 407</u>				
Floor:	VFT & Mastic (9" Olive)	MISC	3 % Ch	5		80 sq No
Baseboard:	Baseboard & Mastic (4" Olive)	MISC	<1 % An	8		36 ln No
Walls:	Canvas Wallpaper	MISC	4 % Ch	7		270 sq No
Walls:	Gypsum Board - Wallpaper	MISC	2 - 4 % Ch	3		324 sq No
Walls:	Wood	NON	Non-Suspect			
Ceiling:	ACT & Mastic on GypBrd (12" Fleasured)	MISC	2 % Ch	4		80 sq No
	<i>Comment: The top 2 feet of all walls are covered with ACT.</i>					

Functional Space Notes

HAZARD MANAGEMENT SERVICES, INC.

Client: Chabot College

Site: Building 400

HMS Project Number: BA00302

Date of Inspection: September 13, 2006

Building: Building 400

Building Comment: *Need to look at attic components*

Materials	Material Class	Percent Asbestos	Hmgns Matrl #	Sampled Here?	Footage Sq/Ln/Jnts	Friable? Yes/No
Building: <u>Building 400</u>		Room: <u>RM 408</u>				
Floor:	VFT & Mastic (9" Olive)	MISC 3 % Ch	5		80 sq	No
Baseboard:	Baseboard & Mastic (4" Olive)	MISC <1 % An	8		36 ln	No
Walls:	Canvas Wallpaper	MISC 4 % Ch	7		270 sq	No
Walls:	Gypsum Board - Wallpaper	MISC 2 - 4 % Ch	3		324 sq	No
Walls:	Wood	NON Non-Suspect				
Ceiling:	ACT & Mastic on GypBrd (12" Fleaured)	MISC 2 % Ch	4		80 sq	No
<i>Comment: The top 2 feet of all walls are covered with ACT.</i>						

Building: <u>Building 400</u>		Room: <u>RM 408</u>				
Floor:	VFT & Mastic (9" Olive)	MISC 3 % Ch	5		80 sq	No
Baseboard:	Baseboard & Mastic (4" Olive)	MISC <1 % An	8		36 ln	No
Walls:	Canvas Wallpaper	MISC 4 % Ch	7		270 sq	No
Walls:	Gypsum Board - Wallpaper	MISC 2 - 4 % Ch	3		324 sq	No
Walls:	Wood	NON Non-Suspect				
Ceiling:	ACT & Mastic on GypBrd (12" Fleaured)	MISC 2 % Ch	4		80 sq	No
<i>Comment: The top 2 feet of all walls are covered with ACT.</i>						

Building: <u>Building 400</u>		Room: <u>RM 410</u>				
Floor:	VFT & Mastic (9" Olive)	MISC 3 % Ch	5		80 sq	No
Baseboard:	Baseboard & Mastic (4" Olive)	MISC <1 % An	8		36 ln	No
Walls:	Canvas Wallpaper	MISC 4 % Ch	7		270 sq	No
Walls:	Gypsum Board - Wallpaper	MISC 2 - 4 % Ch	3		324 sq	No
Walls:	Wood	NON Non-Suspect				
Ceiling:	ACT & Mastic on GypBrd (12" Fleaured)	MISC 2 % Ch	4		80 sq	No
<i>Comment: The top 2 feet of all walls are covered with ACT.</i>						

Functional Space Notes

HAZARD MANAGEMENT SERVICES, INC.

Client: Chabot College

Site: Building 400

HMS Project Number: BA06302

Date of Inspection: September 13, 2006

Building:							Footage	Friable?
Building Comment:							Sq/Ln/Jnts	Yes/No
Materials	Material Class	Percent Asbestos	Hmgns	Sampled	Matri #	Here?		
Building: <u>Building 400</u>	Room: <u>RM 411</u>							
Floor:	VFT & Mastic (9" Olive)	MISC	<u>3 % Ch</u>		5		80 sq	No
Baseboard:	Baseboard & Mastic (4" Olive)	MISC	<u><1 % An</u>		8		36 ln	No
Walls:	Canvas Wallpaper	MISC	<u>4 % Ch</u>		7		270 sq	No
Walls:	Gypsum Board - Wallpaper	MISC	<u>2 - 4 % Ch</u>		3		324 sq	No
Walls:	Wood	NON	Non-Suspect					
Ceiling:	ACT & Mastic on GypBrd (12" Fissured)	MISC	<u>2 % Ch</u>		4		80 sq	No
<i>Comment: The top 2 feet of all walls are covered with ACT.</i>								
Building: <u>Building 400</u>	Room: <u>RM 412</u>							
Floor:	VFT & Mastic (9" Olive)	MISC	<u>3 % Ch</u>		5		80 sq	No
Baseboard:	Baseboard & Mastic (4" Olive)	MISC	<u><1 % An</u>		8		36 ln	No
Walls:	Canvas Wallpaper	MISC	<u>4 % Ch</u>		7		270 sq	No
Walls:	Gypsum Board - Wallpaper	MISC	<u>2 - 4 % Ch</u>		3		324 sq	No
Walls:	Wood	NON	Non-Suspect					
Ceiling:	ACT & Mastic on GypBrd (12" Fissured)	MISC	<u>2 % Ch</u>		4		80 sq	No
<i>Comment: The top 2 feet of all walls are covered with ACT.</i>								
Building: <u>Building 400</u>	Room: <u>RM 413</u>							
Floor:	VFT & Mastic (9" Olive)	MISC	<u>3 % Ch</u>		5		80 sq	No
Baseboard:	Baseboard & Mastic (4" Olive)	MISC	<u><1 % An</u>		8		36 ln	No
Walls:	Canvas Wallpaper	MISC	<u>4 % Ch</u>		7		270 sq	No
Walls:	Gypsum Board - Wallpaper	MISC	<u>2 - 4 % Ch</u>		3		324 sq	No
Walls:	Wood	NON	Non-Suspect					
Ceiling:	ACT & Mastic on GypBrd (12" Fissured)	MISC	<u>2 % Ch</u>		4		80 sq	No
<i>Comment: The top 2 feet of all walls are covered with ACT.</i>								

Functional Space Notes

HAZARD MANAGEMENT SERVICES, INC.

Client: Chabot College

Site: Building 400

HMS Project Number: BA06302

Date of Inspection: September 13, 2006

Building: Building 400
Building Comment: *Need to look at attic components*

Materials	Material Class	Percent Asbestos	Hmngs Matri #	Sampled Here?	Footage Sq/Ln/Jnts	Friable? Yes/No
Building: <u>Building 400</u>		Room: <u>RM 414</u>				
Floor:	VFT & Mastic (9" Olive)	MISC	<u>3 % Ch</u>	5	80 sq	No
Baseboard:	Baseboard & Mastic (4" Olive)	MISC	<u><1 % An</u>	8	36 ln	No
Walls:	Canvas Wallpaper	MISC	<u>4 % Ch</u>	7	270 sq	No
Walls:	Gypsum Board - Wallpaper	MISC	<u>2 - 4 % Ch</u>	3	324 sq	No
Walls:	Wood	NON	Non-Suspect			
Ceiling:	ACT & Mastic on GypBrd (12" Fissured)	MISC	<u>2 % Ch</u>	4	80 sq	No
<i>Comment: The top 2 feet of all walls are covered with ACT.</i>						

Building: <u>Building 400</u>		Room: <u>RM 415</u>				
Floor:	VFT & Mastic (9" Olive)	MISC	<u>3 % Ch</u>	5	80 sq	No
Baseboard:	Baseboard & Mastic (4" Olive)	MISC	<u><1 % An</u>	8	36 ln	No
Walls:	Canvas Wallpaper	MISC	<u>4 % Ch</u>	7	270 sq	No
Walls:	Gypsum Board - Wallpaper	MISC	<u>2 - 4 % Ch</u>	3	324 sq	No
Walls:	Wood	NON	Non-Suspect			
Ceiling:	ACT & Mastic on GypBrd (12" Fissured)	MISC	<u>2 % Ch</u>	4	80 sq	No
<i>Comment: The top 2 feet of all walls are covered with ACT.</i>						

Building: <u>Building 400</u>		Room: <u>RM 416</u>				
Floor:	VFT & Mastic (9" Olive)	MISC	<u>3 % Ch</u>	5	80 sq	No
Baseboard:	Baseboard & Mastic (4" Olive)	MISC	<u><1 % An</u>	8	36 ln	No
Walls:	Canvas Wallpaper	MISC	<u>4 % Ch</u>	7	270 sq	No
Walls:	Gypsum Board - Wallpaper	MISC	<u>2 - 4 % Ch</u>	3	324 sq	No
Walls:	Wood	NON	Non-Suspect			
Ceiling:	ACT & Mastic on GypBrd (12" Fissured)	MISC	<u>2 % Ch</u>	4	80 sq	No
<i>Comment: The top 2 feet of all walls are covered with ACT.</i>						

Functional Space Notes

HAZARD MANAGEMENT SERVICES, INC.

Client: Chabot College

Site: Building 400

HMS Project Number: BA06302

Date of Inspection: September 13, 2006

Building:							Footage	Friable?
Building Comment:							Sq/Ln/Jnts	Yes/No
Materials	Material Class	Percent Asbestos	Hmgns	Sampled	Matri #	Here?		
Building: <u>Building 400</u>		Room: <u>RM 417</u>						
Floor:	VFT & Mastic (9" Olive)	MISC	3 % Ch	5			80 sq	No
Baseboard:	Baseboard & Mastic (4" Olive)	MISC	<1 % An	8			36 ln	No
Walls:	Canvas Wallpaper	MISC	4 % Ch	7			270 sq	No
Walls:	Gypsum Board - Wallpaper	MISC	2 - 4 % Ch	3			324 sq	No
Walls:	Wood	NON	Non-Suspect					
Ceiling:	ACT & Mastic on GypBrd (12" Fissured)	MISC	2 % Ch	4			80 sq	No
<i>Comment: The top 2 feet of all walls are covered with ACT.</i>								
Building: <u>Building 400</u>		Room: <u>RM 418</u>						
Floor:	VFT & Mastic (9" Olive)	MISC	3 % Ch	5			80 sq	No
Baseboard:	Baseboard & Mastic (4" Olive)	MISC	<1 % An	8			36 ln	No
Walls:	Canvas Wallpaper	MISC	4 % Ch	7			270 sq	No
Walls:	Gypsum Board - Wallpaper	MISC	2 - 4 % Ch	3			324 sq	No
Walls:	Wood	NON	Non-Suspect					
Ceiling:	ACT & Mastic on GypBrd (12" Fissured)	MISC	2 % Ch	4			80 sq	No
<i>Comment: The top 2 feet of all walls are covered with ACT.</i>								
Building: <u>Building 400</u>		Room: <u>RM 419</u>						
Floor:	Carpet - Brown w/Triangle Pattern	MISC	None Detected	18	18A		80 sq	
<i>Comment: Glued on top of 9" VFT</i>								
Floor:	VFT & Mastic (9" Olive)	MISC	3 % Ch	5			80 sq	No
Baseboard:	Baseboard & Mastic (4" Olive)	MISC	<1 % An	8			36 ln	No
Walls:	Canvas Wallpaper	MISC	4 % Ch	7			270 sq	No
Walls:	Gypsum Board - Wallpaper	MISC	2 - 4 % Ch	3			324 sq	No
Walls:	Wood	NON	Non-Suspect					
Ceiling:	ACT & Mastic on GypBrd (12" Fissured)	MISC	2 % Ch	4			80 sq	No
<i>Comment: The top 2 feet of all walls are covered with ACT.</i>								

Functional Space Notes

HAZARD MANAGEMENT SERVICES, INC.

Client: Chabot College

Site: Building 400

HMS Project Number: BA06302

Date of Inspection: September 13, 2006

Building: Building 400
Building Comment: *Need to look at attic components*

Materials	Material Class	Percent Asbestos	Hmngs Sampled Matrl # Here?	Footage Sq/Ln/Jnts	Friable? Yes/No
Building: <u>Building 400</u>		Room: <u>RM 420</u>			
Floor:	VFT & Mastic (9" Olive)	MISC	<u>3 % Ch</u>	5	80 sq No
Baseboard:	Baseboard & Mastic (4" Olive)	MISC	<u><1 % An</u>	8	36 ln No
Walls:	Canvas Wallpaper	MISC	<u>4 % Ch</u>	7	270 sq No
Walls:	Gypsum Board - Wallpaper	MISC	<u>2 - 4 % Ch</u>	3	324 sq No
Walls:	Wood	NON	Non-Suspect		
Ceiling:	ACT & Mastic on GypBrd (12" Fissured)	MISC	<u>2 % Ch</u>	4	80 sq No
<i>Comment: The top 2 feet of all walls are covered with ACT.</i>					

Building: <u>Building 400</u>		Room: <u>RM 421</u>			
Floor:	VFT & Mastic (9" Olive)	MISC	<u>3 % Ch</u>	5	80 sq No
Baseboard:	Baseboard & Mastic (4" Olive)	MISC	<u><1 % An</u>	8	36 ln No
Walls:	Canvas Wallpaper	MISC	<u>4 % Ch</u>	7	270 sq No
Walls:	Gypsum Board - Wallpaper	MISC	<u>2 - 4 % Ch</u>	3	324 sq No
Walls:	Wood	NON	Non-Suspect		
Ceiling:	ACT & Mastic on GypBrd (12" Fissured)	MISC	<u>2 % Ch</u>	4	80 sq No
<i>Comment: The top 2 feet of all walls are covered with ACT.</i>					

Building: <u>Building 400</u>		Room: <u>RM 422</u>			
Floor:	VFT & Mastic (9" Olive)	MISC	<u>3 % Ch</u>	5	80 sq No
Baseboard:	Baseboard & Mastic (4" Olive)	MISC	<u><1 % An</u>	8	36 ln No
Walls:	Canvas Wallpaper	MISC	<u>4 % Ch</u>	7	270 sq No
Walls:	Gypsum Board - Wallpaper	MISC	<u>2 - 4 % Ch</u>	3	324 sq No
Walls:	Wood	NON	Non-Suspect		
Ceiling:	ACT & Mastic on GypBrd (12" Fissured)	MISC	<u>2 % Ch</u>	4	80 sq No
<i>Comment: The top 2 feet of all walls are covered with ACT.</i>					

Functional Space Notes

HAZARD MANAGEMENT SERVICES, INC.

Client: Chabot College

Site: Building 400

HMS Project Number: BA06302

Date of Inspection: September 13, 2006

Building: Building 400
Building Comment: *Need to look at attic components*

Materials	Material Class	Percent Asbestos	Hmgns Sampled Here?	Footage Sq/Ln/Jnte	Friable? Yes/No
Building: <u>Building 400</u>		Room: <u>RM 423</u>			
Floor:	VFT & Mastic (9" Olive)	MISC	<u>3 % Ch</u>	5	80 sq No
Baseboard:	Baseboard & Mastic (4" Olive)	MISC	<u><1 % An</u>	8	36 ln No
Walls:	Canvas Wallpaper	MISC	<u>4 % Ch</u>	7	270 sq No
Walls:	Gypsum Board - Wallpaper	MISC	<u>2 - 4 % Ch</u>	3	324 sq No
Walls:	Wood	NON	Non-Suspect		
Ceiling:	ACT & Mastic on GypBrd (12" Fissured)	MISC	<u>2 % Ch</u>	4	80 sq No
<i>Comment: The top 2 feet of all walls are covered with ACT.</i>					

Building: <u>Building 400</u>		Room: <u>RM 424</u>			
Floor:	VFT & Mastic (12" Blue Oatmeal)	MISC	None Detected	1	80 sq
Baseboard:	Baseboard & Mastic (4" Light Green)	MISC	None Detected	17	36 ln
Walls:	Canvas Wallpaper	MISC	<u>4 % Ch</u>	7	270 sq No
Walls:	Gypsum Board - Wallpaper	MISC	<u>2 - 4 % Ch</u>	3	324 sq No
Walls:	Wood	NON	Non-Suspect		
Ceiling:	ACT & Mastic on GypBrd (12" Fissured)	MISC	<u>2 % Ch</u>	4	80 sq No
<i>Comment: The top 2 feet of all walls are covered with ACT.</i>					

Building: <u>Building 400</u>		Room: <u>RM 425</u>			
Floor:	VFT & Mastic (12" Blue Oatmeal)	MISC	None Detected	1	80 sq
Baseboard:	Baseboard & Mastic (4" Light Green)	MISC	None Detected	17	36 ln
Walls:	Canvas Wallpaper	MISC	<u>4 % Ch</u>	7	270 sq No
Walls:	Gypsum Board - Wallpaper	MISC	<u>2 - 4 % Ch</u>	3	324 sq No
Walls:	Wood	NON	Non-Suspect		
Ceiling:	ACT & Mastic on GypBrd (12" Fissured)	MISC	<u>2 % Ch</u>	4	80 sq No
<i>Comment: The top 2 feet of all walls are covered with ACT.</i>					

Functional Space Notes

HAZARD MANAGEMENT SERVICES, INC.

Client: Chabot College

Site: Building 400

HMS Project Number: BA06302

Date of Inspection: September 13, 2006

Building: Building 400
Building Comment: *Need to look at attic components*

Materials	Material Class	Percent Asbestos	Hmgns Matri #	Sampled Here?	Footage Sq/Ln/Jnts	Prable? Yes/No
Building: <u>Building 400</u>		Room: <u>RM 426</u>				
Floor:	VFT & Mastic (9" Olive)	MISC	3 % Ch	5	80 sq	No
Baseboard:	Baseboard & Mastic (4" Light Green)	MISC	None Detected	17	36 ln	
Walls:	Canvas Wallpaper	MISC	4 % Ch	7	7A, 7B	270 sq No
Walls:	Gypsum Board - Wallpaper	MISC	2 - 4 % Ch	3	324 sq	No
Walls:	Wood	NON	Non-Suspect			
Ceiling:	ACT & Mastic on GypBrd (12" Fissured)	MISC	2 % Ch	4	80 sq	No
<i>Comment: The top 2 feet of all walls are covered with ACT.</i>						

Building: <u>Building 400</u>		Room: <u>RM 427</u>				
Floor:	VFT & Mastic (9" Olive)	MISC	3 % Ch	5	80 sq	No
Baseboard:	Baseboard & Mastic (6" Green)	MISC	None Detected	2	36 ln	
Walls:	Canvas Wallpaper	MISC	4 % Ch	7	270 sq	No
Walls:	Gypsum Board - Wallpaper	MISC	2 - 4 % Ch	3	324 sq	No
Walls:	Wood	NON	Non-Suspect			
Ceiling:	ACT & Mastic on GypBrd (12" Fissured)	MISC	2 % Ch	4	4A	80 sq No
<i>Comment: The top 2 feet of all walls are covered with ACT.</i>						

Building: <u>Building 400</u>		Room: <u>RM 428</u>				
Floor:	VFT & Mastic (12" Blue Oatmeal)	MISC	None Detected	1	80 sq	
Baseboard:	Baseboard & Mastic (4" Light Green)	MISC	None Detected	17	36 ln	
Walls:	Canvas Wallpaper	MISC	4 % Ch	7	270 sq	No
Walls:	Gypsum Board - Wallpaper	MISC	2 - 4 % Ch	3	324 sq	No
Walls:	Wood	NON	Non-Suspect			
Ceiling:	ACT & Mastic on GypBrd (12" Fissured)	MISC	2 % Ch	4	80 sq	No
<i>Comment: The top 2 feet of all walls are covered with ACT.</i>						

Functional Space Notes

HAZARD MANAGEMENT SERVICES, INC.

Client: Chabot College

Site: Building 400

HMS Project Number: BA06302

Date of Inspection: September 13, 2006

Building: Building 400
Building Comment: *Need to look at attic components*

Materials	Material Class	Percent Asbestos	Hmngs Matri #	Sampled Here?	Footage Sq/Ln/Jnts	Friable? Yes/No
Building: <u>Building 400</u>		Room: <u>RM 429</u>				
Floor:	Carpet - Cream w/Mastic	MISC	None Detected	13	13A	76 sq
Floor:	VFT & Mastic (12" Brown Marbled)	MISC	None Detected	12	12A	3 sq
	<i>Comment: At entrance only</i>					
Floor:	VFT & Mastic (9" Olive)	MISC	<u>3 % Ch</u>	5		80 sq No
	<i>Comment: Assumed underneath carpet, known underneath entrance 12" tile</i>					
Baseboard:	Wood	NON	Non-Suspect			
	<i>Comment: No mastic, nailed on</i>					
Walls:	Gypsum Board - Wallpaper	MISC	<u>2 - 4 % Ch</u>	3		324 sq No
Walls:	Wallpaper (Multicolor)	MISC	None Detected	14	14A	243 sq
Walls:	Wood	NON	Non-Suspect			
	<i>Comment: Wood nailed over Wood and Gyp Board</i>					
Ceiling:	ACT & Mastic on GypBrd (12" Fissured)	MISC	<u>2 % Ch</u>	4		80 sq No
	<i>Comment: The top 2 feet of all walls are covered with ACT.</i>					

Building: <u>Building 400</u>		Room: <u>RM 430</u>				
Floor:	Carpet - Green	MISC	None Detected	16	16A	80 sq
	<i>Comment: On top of 9" VFT</i>					
Floor:	VFT & Mastic (9" Olive)	MISC	<u>3 % Ch</u>	5		80 sq No
Baseboard:	Baseboard & Mastic (4" Olive)	MISC	<u><1 % An</u>	8	8A	36 ln No
Walls:	Canvas Wallpaper	MISC	<u>4 % Ch</u>	7		270 sq No
Walls:	Gypsum Board - Wallpaper	MISC	<u>2 - 4 % Ch</u>	3		324 sq No
Walls:	Wood	NON	Non-Suspect			
Ceiling:	ACT & Mastic on GypBrd (12" Fissured)	MISC	<u>2 % Ch</u>	4		80 sq No
	<i>Comment: The top 2 feet of all walls are covered with ACT.</i>					

Building: <u>Building 400</u>		Room: <u>RM 431</u>				
Floor:	VFT & Mastic (9" Olive)	MISC	<u>3 % Ch</u>	5		80 sq No
Baseboard:	Baseboard & Mastic (6" Green)	MISC	None Detected	2		36 ln
Walls:	Canvas Wallpaper	MISC	<u>4 % Ch</u>	7		270 sq No
Walls:	Gypsum Board - Wallpaper	MISC	<u>2 - 4 % Ch</u>	3		324 sq No
Walls:	Wood	NON	Non-Suspect			
Ceiling:	ACT & Mastic on GypBrd (12" Fissured)	MISC	<u>2 % Ch</u>	4		80 sq No
	<i>Comment: The top 2 feet of all walls are covered with ACT.</i>					

Functional Space Notes

HAZARD MANAGEMENT SERVICES, INC.

Client: Chabot College

Site: Building 400

HMS Project Number: BA06302

Date of Inspection: September 13, 2006

Building: Building 400

Building Comment: *Need to look at attic components*

Materials	Material Class	Percent Asbestos	Hmgns Matrl #	Sampled Hero?	Footage Sq/Ln/Jnts	Friable? Yes/No
Building: <u>Building 400</u>		Room: <u>RM 432</u>				
Floor:	VFT & Mastic (12" Blue Oatmeal)	MISC	None Detected	1	80 sq	
Baseboard:	Baseboard & Mastic (4" Light Green)	MISC	None Detected	17 17A	36 ln	
Walls:	Canvas Wallpaper	MISC	4 % Ch	7	270 sq	No
Walls:	Gypsum Board - Wallpaper	MISC	2 - 4 % Ch	3 3A	324 sq	No
Walls:	Wood	NON	Non-Suspect			
Ceiling:	ACT & Mastic on GypBrd (12" Fissured)	MISC	2 % Ch	4	80 sq	No
<i>Comment: The top 2 feet of all walls are covered with ACT.</i>						

Building: <u>Building 400</u>		Room: <u>RM 433 Janitor Closet</u>				
Floor:	VFT & Mastic (8" Olive)	MISC	3 % Ch	5	72 sq	No
Baseboard:	Baseboard & Mastic (8" Olive)	MISC	None Detected	24 24A	36 ln	
Walls:	Gypsum Board - Orange Peel	MISC	4 % Ch	10 10A, 10B	324 sq	No
Walls:	Metal	NON	Non-Suspect			
Ceiling:	Gypsum Board - Orange Peel	MISC	4 % Ch	10	72 sq	No
Drain Basin:	Sealant (Basin, Black)	MISC	None Detected	11 11A	3 ln	
<i>Comment: Seal around drain basin in Room 433</i>						

Building: <u>Building 400</u>		Room: <u>RM 434 Workroom</u>				
Floor:	VFT & Mastic (8" Olive)	MISC	3 % Ch	5	180 sq	No
Baseboard:	Baseboard & Mastic (4" Olive)	MISC	<1 % An	8	60 ln	No
Walls:	Gypsum Board - Smooth Texture	MISC	<1 % Ch	9	640 sq	No
<i>Comment: Single Window, Metal Frame</i>						
Ceiling:	ACT & Mastic on GypBrd (12" Fissured)	MISC	2 % Ch	4	180 sq	No
Room Comments:	<i>Room has a sink</i>					

Functional Space Notes

HAZARD MANAGEMENT SERVICES, INC.

Client: Chabot College

Site: Building 400

HMS Project Number: BA06302

Date of Inspection: September 13, 2006

Building: Building 400

Building Comment: *Need to look at attic components*

Materials	Material Class	Percent Asbestos	Hmgns Matri #	Sampled Here?	Footage Sq/Ln/Jnts	Friable? Yes/No
Building: <u>Building 400</u>		Room: <u>RM 436 A</u>				
Floor:	VFT & Mastic (9" Olive)	MISC 3 % Ch	5		96 sq	No
Baseboard:	Baseboard & Mastic (4" Brown)	MISC None Detected	6		40 ln	
Walls:	Canvas Wallpaper	MISC 4 % Ch	7		270 sq	No
Walls:	Gypsum Board - Wallpaper	MISC 2 - 4 % Ch	3		360 sq	No
Walls:	Wood	NON Non-Suspect				
Ceiling:	ACT & Mastic on GypBrd (12" Fissured)	MISC 2 % Ch	4		115 sq	No
<i>Comment: The top 2 feet of all walls are covered with ACT.</i>						

Building: <u>Building 400</u>		Room: <u>RM 437</u>				
Floor:	VFT & Mastic (9" Olive)	MISC 3 % Ch	5	5A	180 sq	No
Baseboard:	Baseboard & Mastic (4" Brown)	MISC None Detected	6	6A	56 ln	
Walls:	Canvas Wallpaper	MISC 4 % Ch	7		504 sq	No
Walls:	Gypsum Board - Wallpaper	MISC 2 - 4 % Ch	3		504 sq	No
Ceiling:	ACT & Mastic on GypBrd (12" Fissured)	MISC 2 % Ch	4		180 sq	No

Functional Space Notes

HAZARD MANAGEMENT SERVICES, INC.

Client: Chabot College

Site: Building 400

HMS Project Number: BA06302

Date of Inspection: September 13, 2006

Building: Building 400

Building Comment: *Need to look at attic components*

Materials	Material Class	Percent Asbestos	Hmgs Sampled Matrl # Here?	Footage Friable? Sq/Ln/Jnts Yes/No
------------------	-----------------------	-------------------------	-----------------------------------	---

Non-Inspected Rooms and Comments:

Building 400 - Attic