



CHABOT- LAS POSITAS COMMUNITY COLLEGE DISTRICT

Facilities Planning & Management Department

February 5, 2010

Addendum No. 1 INVITATION FOR BID NO.: 10-05 Soccer Improvements - Chabot College

All Prospective Bidders:

This addendum is issued to clarify, add, delete, correct and/or change the contract documents to the extent indicated and is hereby made a part of the above noted contract documents on which the contract will be based. Any modifications/changes made by this addendum affect only the portions or paragraphs specifically identified herein; all remaining portions of the proposal to remain in force. It is the responsibility of all bidders to conform to this addendum. Acknowledge receipt of this addendum in the space provided on the bid form. Failure to do so may subject Bidder to Disqualification.

The original Bid Documents shall have the following clarification and modification by the revision as follows:

<i>Item</i>	<i>Location in Contract Documents</i>	<i>Description</i>
RFI's from Contractors		
1-1.	The Irrigation Legend calls for 6" main line to be C-900/Class 200 but the specification calls for 6" main to be Class 315 Purple Pipe. Which is correct?	See Item 1-7.
1-2.	Irrigation Legend calls for extra control wires to be stubbed in gate valve box; a) Are extra wires to loop entire mainline? b) How many wires are to be installed?	See Item 1-11.
1-3.	Specifications call for purple P.V.C. fittings are NOT manufactured in purple, please advise.	Purple pipe is sufficient and fittings are as outlined in 1-7.

1-4.	Planting Legend Sht. No. C-9.0 & Sec. 2900-6/2.07A1 call for sod to Tifway II Hybrid Bermuda Sod, but in paragraph 2.07B, it lists sod as Sports Turf Sod. Which is correct?	Specification Section 02900, 2.07B shall be deleted.
1-5.	Substitution of Scoreboard and Bleachers	The College has only Daktronics scoreboard equipment and will not accept an equal. Specifications for bleacher substitution need to be presented for side-by-side comparison by the contractor and will be entertained if proven to be an equal.

Design Modifications / Clarifications by Landscape Architect & Client

Project Plans

1-6.	Sheet C7.0 and E1.1	<p>The location of scoreboard has been changed as shown on the attached Drawing Attachment #1 to a point between the northwestern property line and the new concrete walkway. Electrical changes for underground Conduit Routing/Requirements are shown on Drawing Attachment SKE-1.</p> <p>Revise Sheet E1.1, Note #2 to read: “Provide and install (N) Sportsfield Specialties COM BOX 3500 in turf , flush against concrete walk with artificial infill turf kit pre-installed at the factory. Provide and install dedicated power connection for scorer’s table (one circuit to serve both locations). Contractor shall coordinate exact location and requirements with Architect. Refer to Detail #3, E2.1 for further requirements. Route (3) #4 AWG wires back to (E) 208Y/120V Panelboard located in Substation “E,” via (E) and (N) underground conduits shown. Contractor shall provide (N) 20A/1P dedicated circuit breaker in panelboard’s available space. Contractor shall verify and match (E) panel’s AIC, Type and Frame-Style.” REVISE Sheet Note # 3 to read: “Provide and install dedicated power connection for irrigation controller. Contractor shall coordinate exact location and requirements with irrigation controller installer. Route (3) #6 AWG wires back to (E) 208Y/120V Panelboard located in Substation “E,” via (E) and (N) underground conduits shown. Contractor shall provide (N) 20A/1P dedicated circuit breaker in panelboard’s available space. Contractor shall verify and match (E) panel’s AIC, Type and Frame-Style.” REVISE Sheet Note # 5 to read: “Provide Nema-3R junction boxes for power and signal at new scorboard. Contractor shall connect power and controls as required. Route control cable in signal</p>
------	---------------------	---

		conduit shown back to scorer's table in-grade pull box locations. Provide control cable per scoreboard manufacturer's recommendation. Provide and install dedicated power connection for scoreboard. Contractor shall coordinate exact location and requirements with scoreboard installer. Route (3) #4 AWG wires back to (E) 208Y/120V Panelboard located in Substation "E," via (E) and (N) underground conduits shown. Contractor shall provide (N) 20A/1P dedicated circuit breaker in panelboard's available space. Contractor shall verify and match (E) panel's AIC, Type and Frame-Style."
1-7.	Sheet C8.0, Irrigation Legend, Mainline.	Mainlines 3" and smaller, shall be Purple-NP ASTM D-2241 PVC DR 13.5, (Pressure Rating 315 PSI), Solvent weld. Mainlines 4" and larger, shall be Purple-NP AWWA C900 DR14 (Pressure Class 200 PSI) with Ductile Iron fittings and mechanical joint restraint conforming to ASTM F1674 as follows. Straight C-900 PVC Bell fittings shall receive JCM Industries, Inc. 620 Sur-Grip Joint Restrainer or approved equivalent. Ductile iron fittings shall be restrained with JCM Industries, Inc. 610 Sur-Grip Fitting Restrainers or approved equivalent. All Restrainers shall receive two layers of Bituminous Coating. Thrust blocks shall be installed per Sheet D4.0, Detail B.
1-8.	Sheet C8.0, Irrigation Legend and Plan, Rotors.	Where noted on the plans as Hunter I-40-06-SS-R equals I-40-06-SS-R with #40 Nozzle, Hunter I-41-06-SS-R equals I-40-06-SS-R with #41 Nozzle & Hunter I-44-06-SS-R equals I-40-06-SS-R with #44 Nozzle.
1-9.	Sheet C8.0, Irrigation Legend and Plan, Heads.	All MPR40 Hunter Pop-up bodies with MP Rotary Nozzles are to be changed to Rainbird 1800-SAM P45 Series bodies with MP Rotary Nozzles sized per legend.
1-10.	Sheet C8.0, Irrigation Plan	While the location of the valves are diagramatic, valve boxes shall be located adjacent to hardscape per Sheet D4.0, Detail G and per the Drawing Attachment 2.0 (attachment).
1-11.	Sheet C8.0, Irrigation Legend, stub out mainline and place extra control wires in gate valve box	Change to read "place extra wire for six control valves with a 36" wire coil wrapped in the valve box at each mainline stub."
1-12.	Sheet D2.0, H	The note stating Blue Rye Grass shall be changed to 6" Decomposed Granite Fines.
Project Manual		
1-13.	Specification Section 02810, 2.02,A	Delete A in Specifications and replace with Item 1-7 above.
1-14.	Specification Section 02810, 2.07F	Delete the note that states that "The color of plastic boxes shall be purple" and change it to read "The color of plastic boxes shall be green and color for concrete boxes shall be natural."
1-15.	Specification Section 02900,	Change the size of "rock, stones, rubble, clay, clods, etc.

	2.01A	over 2" in diameter" to one inch in diameter.
1-16.	Specification Section 02900, 2.07A1	This item will be modified to read "Sod shall be nursery grown certified Tifway II (Cynodon dactylox C. transvaalensis) as classified in the ASPA GSS. Sod shall be sand-based. Sod supplier shall certify that the sod was grown on a minimum of 85% sand-based root zone. No netting or plastic grids will be left on, in or under sod after planting. Machine cut thickness of 1/2 inch, excluding top growth and thatch. Sod shall be "Big Roll". Sod shall be strong enough to support a 24 inch square by its own weight when lifted by the ends. Sod shall be composed of healthy living stolons and rhizomes providing a heavy and dense sod not less than 4 months old. Obtain sod only from approved source throughout the duration of the project."
1-17.	Specification Section 02900, 2.07B	Delete this section.
1-18.	Specification Section 02900, 3.07A1 & 3.07A2	Replace with the following: 1. First mowing shall take place when turf has reached a maximum height of 1.5 inches or exhibited strong, uniform growth overall and is more than 1 inch in height. Turf shall be mown to remove no more than 1/3 of turf blade height. Mowing shall be done with a reel mower. Submit written request to the Owner's Representative for acceptability of initiating first mowing. 2. Thereafter, turf shall be mown at least once each week until all turf is sod-like in appearance and quality, and all other contract requirements shall be fulfilled prior to allowing the maintenance period to commence.
1-19.	Specification Section 02970, 3.02A1	Replace with the following: 1. Turf shall not be allowed to exceed 1.5 inches in height and shall not be mown shorter than three quarter inches (0.75") in height. All mowing for Bermuda turf shall be by a reel mower with sharp, clean blades. Turf shall be well established, free of bare spots and weeds, and of a "sod-like" quality to the satisfaction of the Owner's Representative prior to Final Acceptance.

If you have any questions regarding this Addendum No.1, please contact the Office of the Facilities Planning & Management in **writing, via facsimile or email**. All other terms and conditions of BID No.10-05 are to remain the same.

Regards,

Victoria L. Lamica
Contract Manager
vlamica@clpccd.org

F:\Projects\2008\0807600-0593 - Chabot Soccer\Cad\CS-Phase\Addenda\Addendum 1-DA2-Irrigation Box Layout.dwg

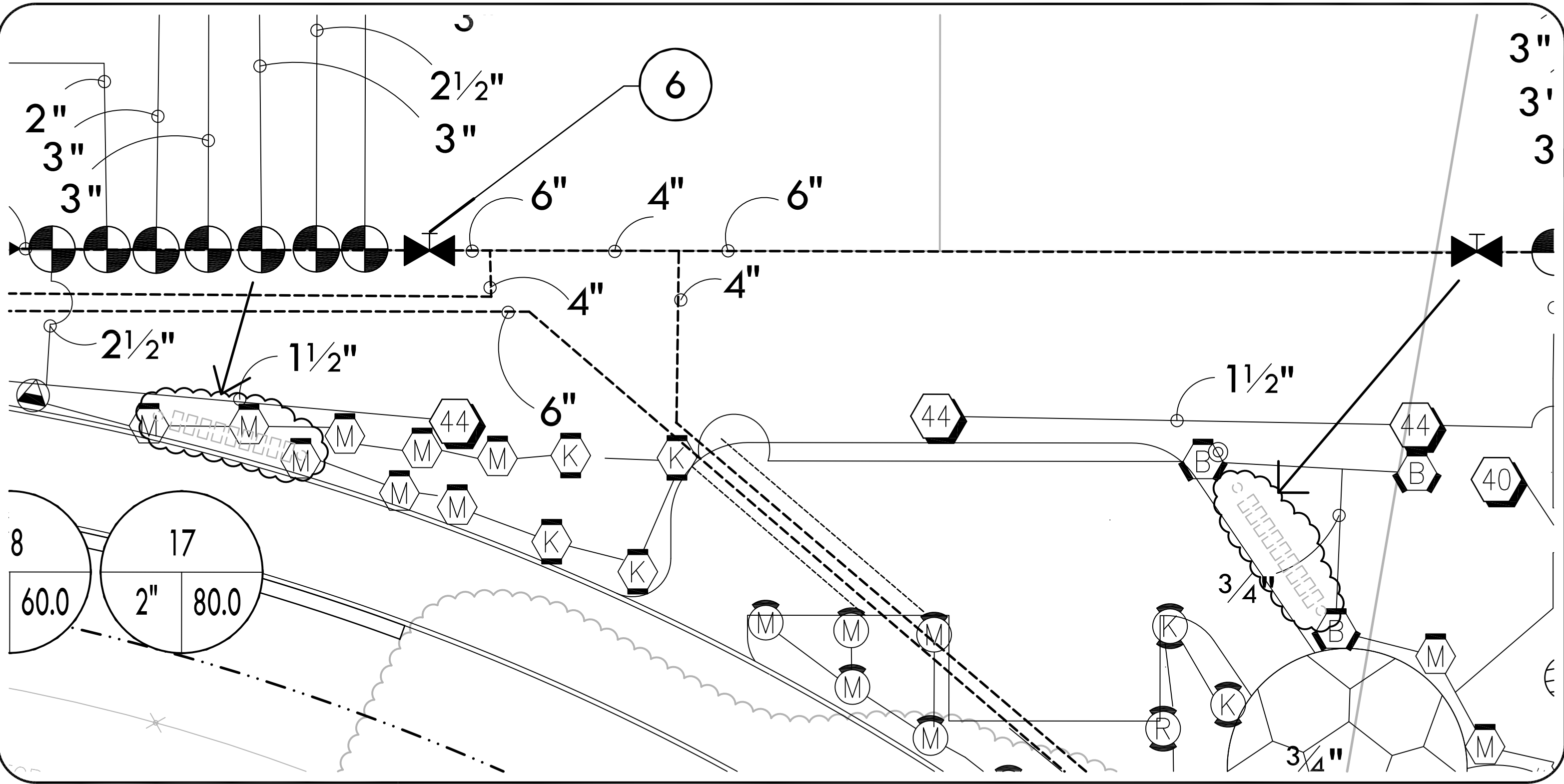

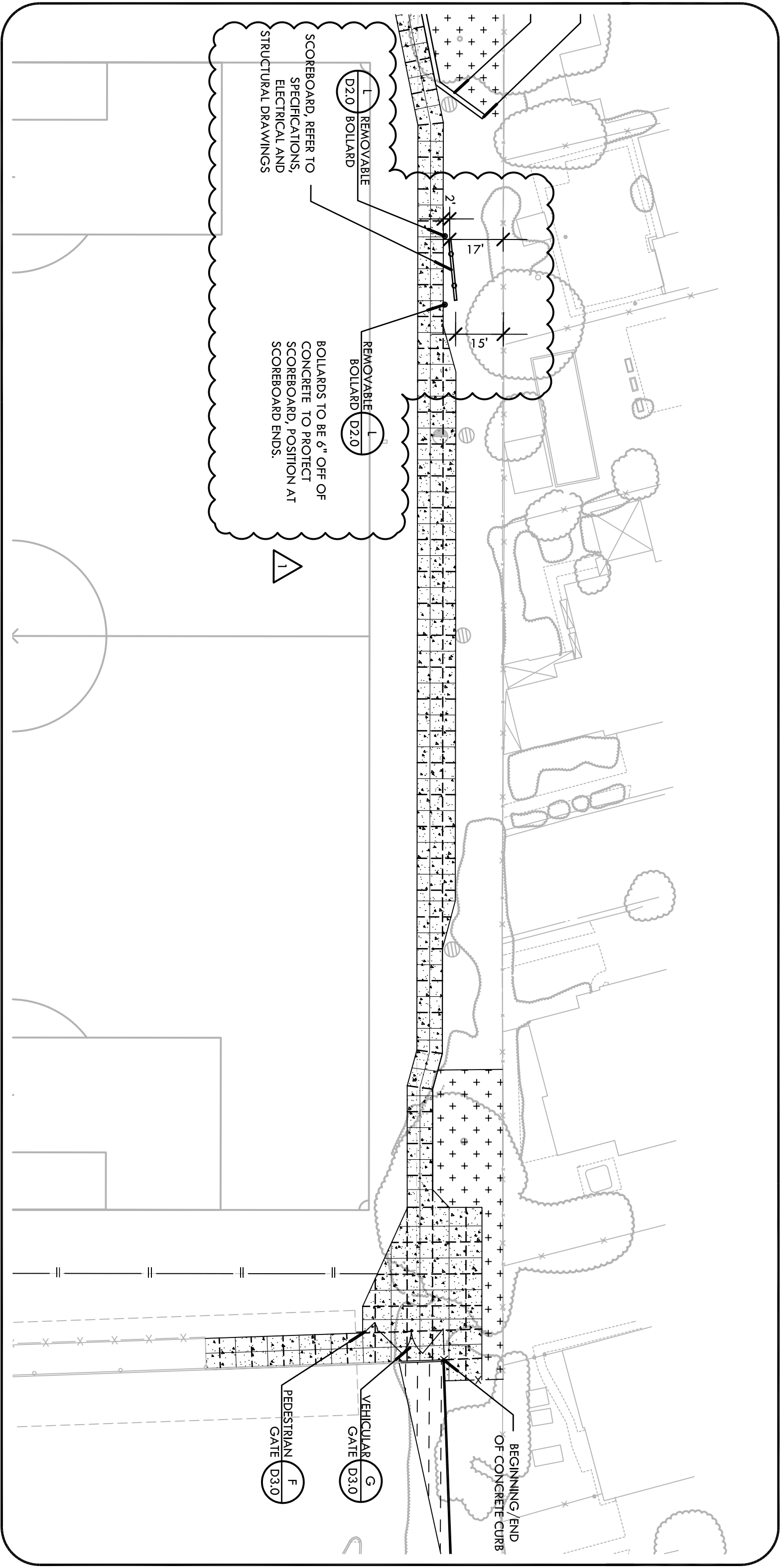

VERDE DESIGN
 LANDSCAPE ARCHITECTURE
 CIVIL ENGINEERING
 SPORT PLANNING & DESIGN
 2455 The Alameda, Ste. 200
 Santa Clara, CA 95050
 tel: 408.985.7200
 fax: 408.985.7260
 www.verdedesigninc.com

CHABOT SOCCER IMPROVEMENTS
ADDENDUM # 1
NEW SCOREBOARD LOCATION



PROJECT# 0807600-0593
 Checked By: DB

Date: 02/01/09
 SCALE: 1" = 30'

DA1.0

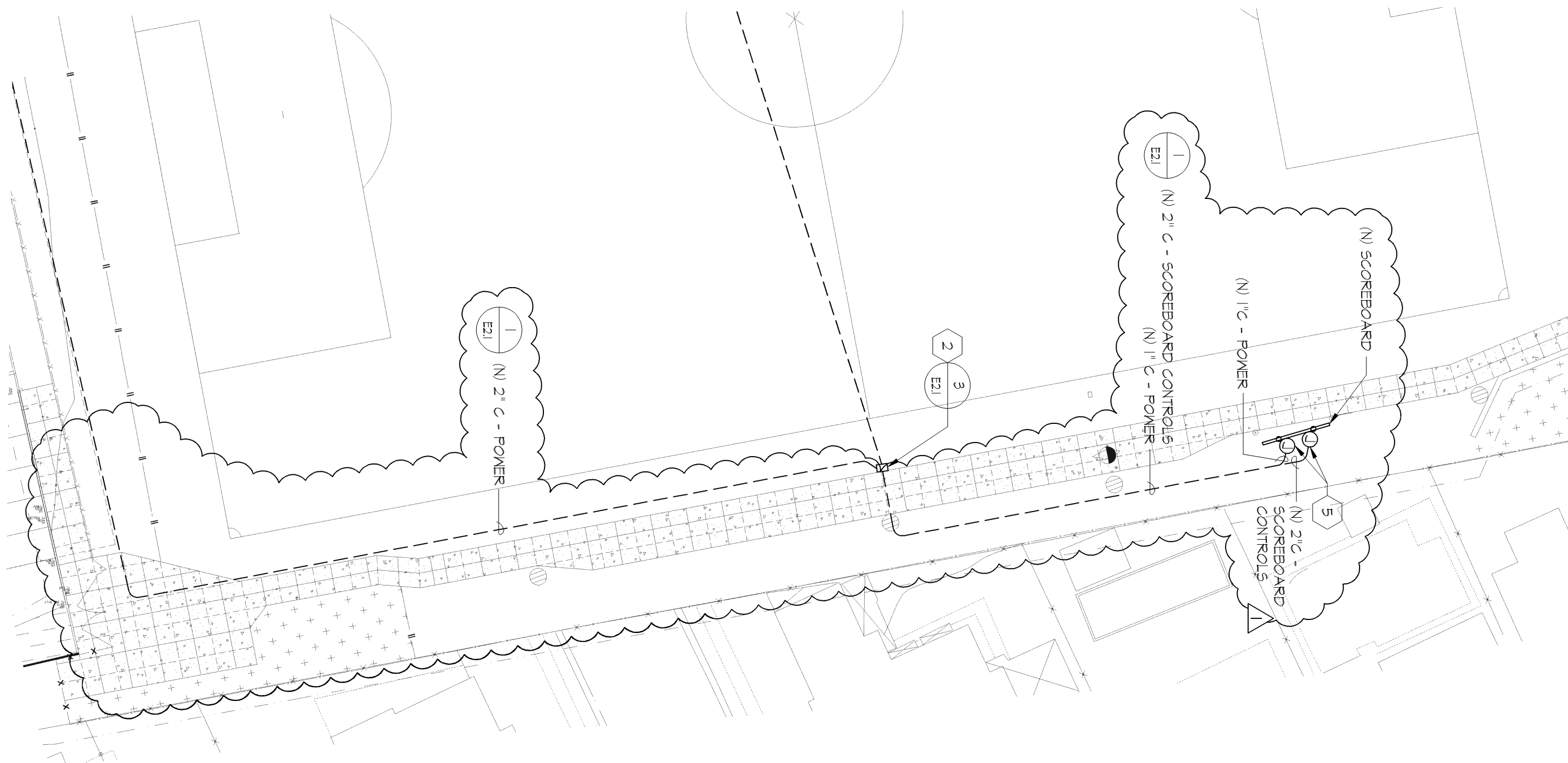

1 PARTIAL ELECTRICAL SITE PLAN
 SKE-1 SCALE: 1" = 30'-0"

VERDE DESIGN
 LANDSCAPE ARCHITECTURE
 CIVIL ENGINEERING
 SPORT PLANNING & DESIGN
 2455 The Alameda, Ste. 200
 Santa Clara, CA 95050
 tel: 408.985.7200
 fax: 408.985.7260
 www.verdedesigninc.com



**American Consulting Engineers
 Electrical, Inc.**
 100 Saratoga Avenue, Suite 200
 Santa Clara, Ca 95051
 JOB # E29081.00
 408/236-2312
 Fax: 408/236-2316

**CHABOT SOCCER IMPROVEMENTS
 ADDENDUM #1
 NEW SCOREBOARD LOCATION**

PROJECT# 0807600-0593

Date: 02/04/10

Checked By:

SCALE: 1" = 30'-0"

1 ADDENDUM #1

SKE-1